



# **PRODUCT CATALOGUE**

## **SILICONE IMPLANTS**

DPS Technology Development Limited  
Tel: +86-755-8327 8885 FAX: +86-755-8327 8884  
E-mail: [info@dpsmedical.com](mailto:info@dpsmedical.com)  
Http: [//www.dpsmedical.com](http://www.dpsmedical.com)



DPS HongKong  
[www.dpsmedical.com](http://www.dpsmedical.com)

The DPS REFINEX Laboratory was founded in 1994 and is the most important silicone implant manufacturer in China. We produce

- Silicone gel breast implants
- Facial implants
- Tissue expanders

All the cohesive silicone gel materials are imported from USA with American FDA approval. We are using the most advanced cohesive silicone gel which is also used by other leading laboratories. All the implants are low-bleed shelled which minimizes the silicone gel diffusion. The world's most advanced barrier-coat technology is applied.

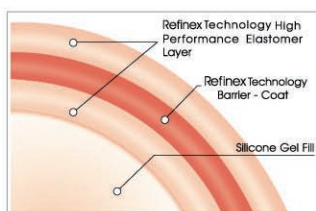

#### • Surface

We provide 3 types of surface: **Smooth, textured and micro-textured** which may lower the risk of the capsular contracture.

#### • Fillings

3 types of fillings of cohesive gel are available: 99%, 95% and 85%. They can meet different needs of different surgeons and patients.

We provide a wide range of choices -- 222 round breast implants with a wide variety of sizes and fillings.

All the products are made in GMP factories strictly in accordance with the international quality control system of ISO9001 and ISO13485.

Refinex offers the surgeons and patients more affordable prices for highest quality products.

### Features of Refinex Implants:

#### SAFE

The world's most advanced cohesive silicone gel is used. The special barrier-coat technology prevents the gel leaking. The special textured surface optimizes tissue adherence and minimizes the occurrence of capsular contracture.

#### NATURAL

The cohesive silicone gel has intelligent memory function and will come back to its original forms even after heavy pressure. The softness is very close to breast tissues.



# Contents

I High profile (99% filled).....	1
II High profile (85% filled).....	2
III Middle profile (99% filled).....	2
IV Middle profile (95% filled).....	3
V Low profile (99% filled).....	3
VI Low profile (95% filled).....	4

We provide **Smooth, textured and micro-textured** surface for each size of breast implants. Totally there are 222 choices.

Currently we only produce round breast implants. But our anatomical implants are already available and sizes can be custom-made.

All the products are produced strictly according to ISO9001 and ISO13485. Each product is traceable by a unique tracking number.

**Note:** This product catalogue is available in PDF file in the website: [www.dpsmedical.com](http://www.dpsmedical.com) and [www.refinex.cc](http://www.refinex.cc)

© Copyright - DPS Technology Development Ltd.



# Breast implants

DPS Refinex offers 74 different sizes of round breast implants filled with soft cohesive silicone gel. Each size has textured or smooth surface. Totally there are 222 different choices.

Projection		Low 10	Middle 20	High 30
Smooth surface	99% filled	SC1099	SC2099	SC3099
	95% filled	SC1095	SC2095	SC3085 (85% filled)
Textured surface	99% filled	TC1099	TC2099	TC3099
	95% filled	TC1095	TC2095	TC3095
Micro-Textured surface	99% filled	MC1099	MC2099	MC3099
	95% filled	MC1095	MC2095	MC3085 (85% filled)

## Round soft cohesive gel High Profile (99% filled) 3099

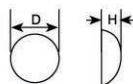

Size (g)	Catalog Number			Diameter (cm)	Height (cm)
	Smooth Surface	Textured Surface	Micro-Textured Surface		
140	SC3099140	TC3099140	MC3099140	7.7	4.2
160	SC3099160	TC3099160	MC3099160	8.0	4.4
180	SC3099180	TC3099180	MC3099180	8.3	4.6
200	SC3099200	TC3099200	MC3099200	8.7	4.8
220	SC3099220	TC3099220	MC3099220	9.1	5.0
240	SC3099240	TC3099240	MC3099240	9.4	5.2
260	SC3099260	TC3099260	MC3099260	9.7	5.4
280	SC3099280	TC3099280	MC3099280	10.0	5.6
300	SC3099300	TC3099300	MC3099300	10.2	5.8
325	SC3099325	TC3099325	MC3099325	10.5	5.9
350	SC3099350	TC3099350	MC3099350	10.8	6.0
375	SC3099375	TC3099375	MC3099375	11.0	6.1
400	SC3099400	TC3099400	MC3099400	11.2	6.2
430	SC3099430	TC3099430	MC3099430	11.4	6.3
460	SC3099460	TC3099460	MC3099460	11.6	6.4



## Round soft cohesive gel High Profile (85% filled) 3085

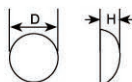

High Profile (85% filled)					
Size (g)	Catalog Number			Diameter (cm)	Height (cm)
	Smooth Surface	Textured Surface	Micro-Textured Surface		
140	SC3085140	TC3085140	MC3085140	8.8	3.1
160	SC3085160	TC3085160	MC3085160	9.0	3.2
180	SC3085180	TC3085180	MC3085180	9.3	3.3
200	SC3085200	TC3085200	MC3085200	9.6	3.5
220	SC3085220	TC3085220	MC3085220	10.0	3.7
240	SC3085240	TC3085240	MC3085240	10.3	4.0
260	SC3085260	TC3085260	MC3085260	10.6	4.1
280	SC3085280	TC3085280	MC3085280	10.9	4.15
300	SC3085300	TC3085300	MC3085300	11.2	4.2
320	SC3085320	TC3085320	MC3085320	11.5	4.25
340	SC3085340	TC3085340	MC3085340	11.8	4.3
360	SC3085360	TC3085360	MC3085360	12.1	4.4
380	SC3085380	TC3085380	MC3085380	12.4	4.5
400	SC3085400	TC3085400	MC3085400	12.7	4.6

## Round soft cohesive gel Middle Profile (99% filled) 2099

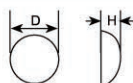

Middle Profile (99% filled)					
Size (g)	Catalog Number			Diameter (cm)	Height (cm)
	Smooth Surface	Textured Surface	Micro-Textured Surface		
175	SC2099175	TC2099175	MC2099175	9.5	3.8
195	SC2099195	TC2099195	MC2099195	9.6	4.0
205	SC2099205	TC2099205	MC2099205	9.7	4.2
230	SC2099230	TC2099230	MC2099230	10.1	4.2
250	SC2099250	TC2099250	MC2099250	10.4	4.3
270	SC2099270	TC2099270	MC2099270	10.6	4.3
295	SC2099295	TC2099295	MC2099295	10.7	4.5
325	SC2099325	TC2099325	MC2099325	11.4	4.6
365	SC2099365	TC2099365	MC2099365	11.7	4.7
390	SC2099390	TC2099390	MC2099390	12.1	5.0
425	SC2099425	TC2099425	MC2099425	12.5	5.1



## Round soft cohesive gel Middle Profile (95% filled) 2095

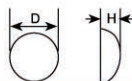

Middle Profile (95% filled)					
Size (g)	Catalog Number			Diameter (cm)	Height (cm)
	Smooth Surface	Textured Surface	Micro-Textured Surface		
170	SC2095170	TC2095170	MC2095170	9.2	3.4
190	SC2095190	TC2095190	MC2095190	9.4	3.5
200	SC2095200	TC2095200	MC2095200	9.6	3.6
225	SC2095225	TC2095225	MC2095225	10.0	3.8
240	SC2095240	TC2095240	MC2095240	10.2	4.0
260	SC2095260	TC2095260	MC2095260	10.4	4.1
285	SC2095285	TC2095285	MC2095285	10.8	4.2
315	SC2095315	TC2095315	MC2095315	11.3	4.4
355	SC2095355	TC2095355	MC2095355	11.6	4.5
375	SC2095375	TC2095375	MC2095375	11.9	4.7
410	SC2095410	TC2095410	MC2095410	12.0	5.0

## Round soft cohesive gel Low Profile (99% filled) 1099

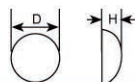

Low Profile (99% filled)					
Size (g)	Catalog Number			Diameter (cm)	Height (cm)
	Smooth Surface	Textured Surface	Micro-Textured Surface		
160	SC1099160	TC1099160	MC1099160	9.5	3.0
180	SC1099180	TC1099180	MC1099180	9.9	3.1
200	SC1099200	TC1099200	MC1099200	10.0	3.7
220	SC1099220	TC1099220	MC1099220	10.4	4.0
240	SC1099240	TC1099240	MC1099240	10.7	4.0
260	SC1099260	TC1099260	MC1099260	10.8	4.1
280	SC1099280	TC1099280	MC1099280	10.9	4.1
300	SC1099300	TC1099300	MC1099300	11.8	4.2
320	SC1099320	TC1099320	MC1099320	11.9	4.4
340	SC1099340	TC1099340	MC1099340	12.1	4.4
360	SC1099360	TC1099360	MC1099360	12.4	4.5
380	SC1099380	TC1099380	MC1099380	12.7	4.6



**Round soft cohesive gel  
Low Profile (95% filled) 1095**

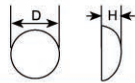

Size (g)	Catalog Number			Diameter (cm)	Height (cm)
	Smooth Surface	Textured Surface	Micro-Textured Surface		
155	SC1095155	TC1095155	MC1095155	9.4	3.1
175	SC1095175	TC1095175	MC1095175	9.7	3.3
190	SC1095190	TC1095190	MC1095190	9.9	3.5
210	SC1095210	TC1095210	MC1095210	10.2	3.6
230	SC1095230	TC1095230	MC1095230	10.5	3.7
250	SC1095250	TC1095250	MC1095250	10.8	3.8
270	SC1095270	TC1095270	MC1095270	11.2	3.9
290	SC1095290	TC1095290	MC1095290	11.5	4.0
310	SC1095310	TC1095310	MC1095310	11.8	4.0
350	SC1095350	TC1095350	MC1095350	12.2	4.0
370	SC1095370	TC1095370	MC1095370	12.4	4.1



*Life Sciences Worldwide*